

PLAN DE AMPLASAMENT SI DELIMITARE A IMOBILULUI
 (intrare/lan) Scara 1:2000

Nr. Suprafata masurata a imobilului (mp)	Adresa imobilului
124952	Intravilan, Aleea Mihail Sadoveanu nr. 4-6-8, Mun. Iasi, jud. Iasi
Nr. Cartea Funciara	Unitatea Administrativ-Teritoriala (UAT)
124952	Mun. Iasi

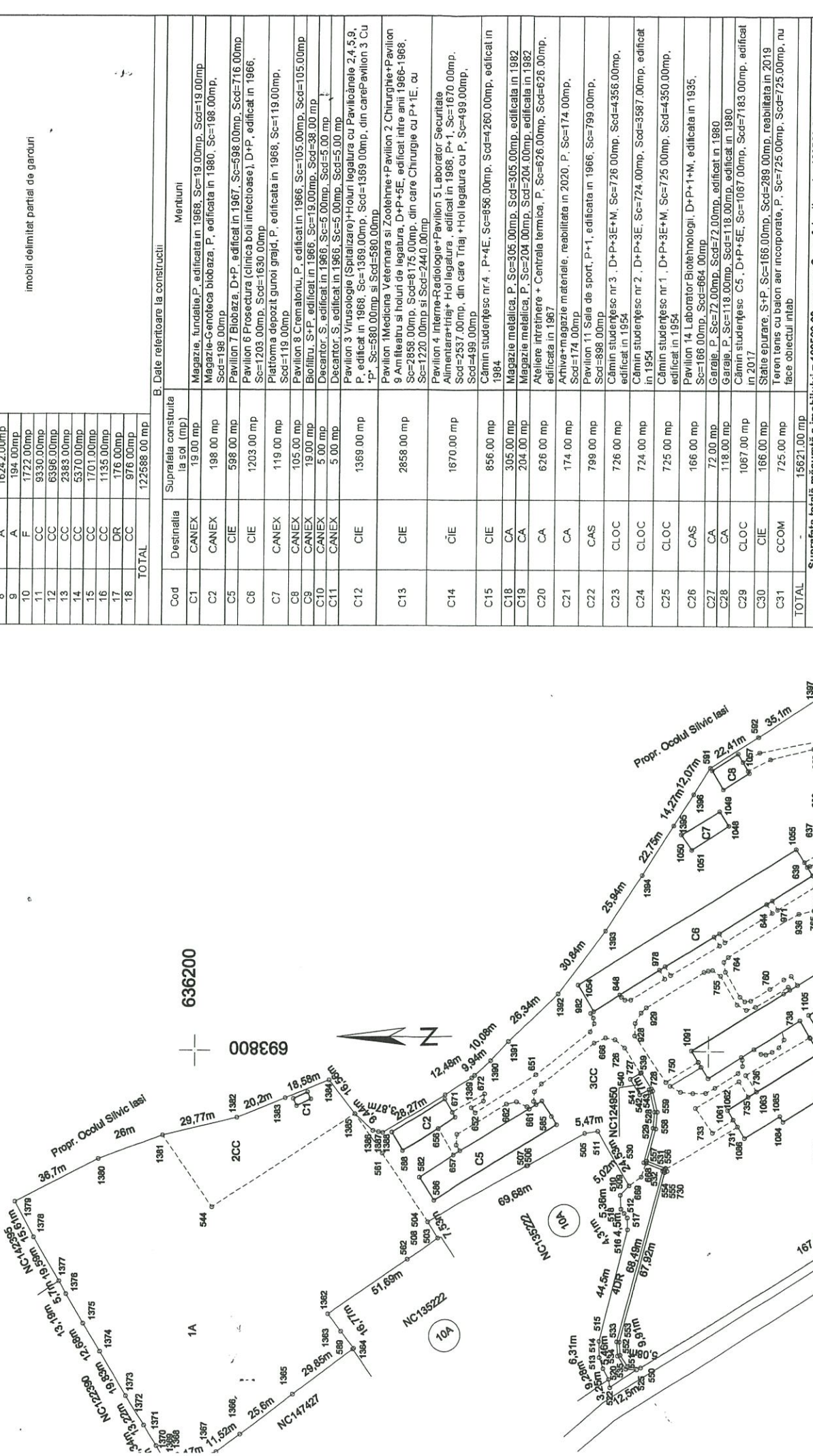

A. Date referitoare la teren		
Nr. parcela	Categ. De	Suprafata (mp)
1	A	12015.00mp
2	CC	1567.00mp
3	CC	28664.00mp
4	DR	700.00mp
5	CC	22891.00mp
6	DR	527.00mp
7	DR	11399.00mp
8	A	16242.00mp
9	A	184.00mp
10	F	1722.00mp
11	CC	9330.00mp
12	CC	6396.00mp
13	CC	2383.00mp
14	CC	5370.00mp
15	CC	1701.00mp
16	CC	1135.00mp
17	DR	176.00mp
18	CC	976.00mp
TOTAL		122568.00 mp

B. Date referitoare la constructii		
Cod	Destinatia	Suprafata construita la sol (mp)
C1	CANEX	19.00 mp
C2	CANEX	198.00 mp
C5	CIE	598.00 mp
C6	CIE	1203.00 mp
C7	CANEX	119.00 mp
C8	CANEX	105.00 mp
C9	CANEX	19.00 mp
C10	CANEX	5.00 mp
C11	CANEX	5.00 mp
C12	CIE	1369.00 mp
C13	CIE	2858.00 mp
C14	CIE	1670.00 mp
C15	CIE	856.00 mp
C18	CA	305.00 mp
C19	CA	204.00 mp
C20	CA	626.00 mp
C21	CA	174.00 mp
C22	CAS	799.00 mp
C23	CLOC	726.00 mp
C24	CLOC	724.00 mp
C25	CLOC	725.00 mp
C26	CAS	166.00 mp
C27	CA	72.00 mp
C28	CA	118.00 mp
C29	CLOC	1067.00 mp
C30	CIE	166.00 mp
C31	CCOM	725.00 mp
TOTAL		15621.00 mp

Suprafata totala masurata a imobilului = 122568.00 mp mp, Suprafata din act = 122568.00 mp mp

Ing. FRUNZA A. DANIELA GINA
 Confirm executarea masuratorilor la teren, corectitudinea intocmirii documentatiei cadastrale si corespondenta acesteia cu realitatea din teren

Executant
 Semnatura si stampila

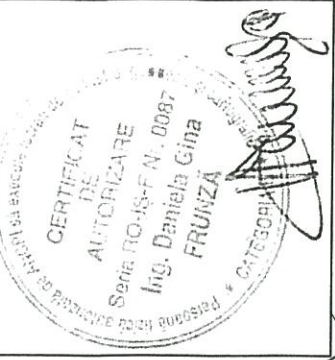

Elena-Mona Popescu
 Date: 2020.04.27
 18:59:42 +03'00"

